

the Maltings

ELY RIVERSIDE



**CONFERENCES,
MEETINGS & EVENTS**

WELCOME

East Cambridgeshire's premiere events & conferencing venue.

The Maltings, alongside the Cathedral, is arguably one of the City's distinguishing landmarks. Set in the beautiful surroundings of Ely riverside, with stunning views over the River Ouse and Marina. It is the perfect venue for any number of guests from 20 to 300.

We are able to cater for a wide range of events, including meetings, conferencing, training events, exhibitions, weddings, other celebrations, and general private hire. We also present a number of live events on stage throughout the year, from theatre to live music, comedy and much more.

We pride ourselves on our friendly and high quality service. We are a fully licensed venue, able to provide a staffed licensed bar for any occasion until late, and are also licensed for wedding ceremonies.

The Maltings includes 3 main areas available for hire. The beautiful Kempen room which overlooks the marina; ideal for meetings and conferencing and smaller wedding ceremonies. To the atmospheric main Elysian Hall, which can accommodate up to 300 guests and includes a full stage, green room and changing rooms. The whole venue has capacity for 400 people at any given time.

Located a short distance from the centre of Ely, with excellent road links to the A14, A1 and M11. Ely's rail station is just a 5 minute walk away, with quick links to Cambridge and the surrounding areas.

We are able to offer a number of free parking spaces for event organisers on site. Further free parking is available just a 2 minute walk from the venue.

We look forward to welcoming you to our beautiful venue.

FUNCTION ROOMS

We are able to offer 4 separate areas within The Maltings, and aim to meet your full requirements. For larger scale events we are also able to offer whole or part venue hire options.



THE ELYSIAN HALL

This atmospheric hall, with high vaulted ceilings, situated on the ground floor, is ideal for large functions and is a highly versatile space. The main stage in the hall acts as a great focal point for any large scale event, and includes a green room and upstairs changing area for artists and performers. Our fully licensed bar is situated next to the main hall, with easy access.



THE KEMPEN ROOM

The beautifully light and airy Kempen room, is based upstairs and overlooks the stunning riverside marina. The perfect space for meetings, conferences, and wedding ceremonies with a max capacity of up to 70 people. We also have a projector and screen available for hire.



THE ORSAY BAR LOUNGE

Situated to the side of our main stage on the ground floor, we are licensed until late, and also able to offer a café style operation on request, making this space ideal for smaller informal networking events. The area can also be partitioned off to create a private meeting room space which can accommodate up to 12 people.



GROUND FLOOR FOYER

Through the main entrance to the venue, the ground floor welcome foyer has lovely views of the marina and river. This space is usually booked as part of a whole or part venue hire as it makes an ideal welcome or registration area. It can also be used as a base for your guest break-out refreshments, or as a more intimate space for smaller groups to meet.

LAYOUT OPTIONS

	THEATRE	CLASS ROOM	BOARD ROOM	BANQUET	U-SHAPE	STAND-ING	DIMS'
ELYSIAN HALL	242	100	-	150 (NO ROOM FOR DANCE FLOOR)	70	200	H: 10m L: 17m W: 10m A: 170m ²
KEMPEN ROOM	70	36	35	50	30	70	H: 3m L: 9m W: 9m A: 81m ²
ORSAY LOUNGE	15	-	10	-	-	20	H: 3m L: 13m W: 4m A: 52m ²

H = height L = length W = width A = area
Numbers given are maximum delegates for each option.

THEATRE

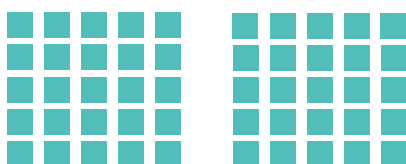

CLASSROOM



BOARDROOM



BANQUET

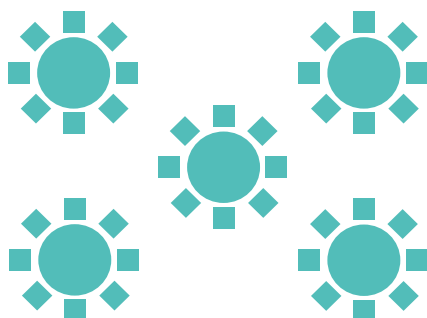

U-SHAPE

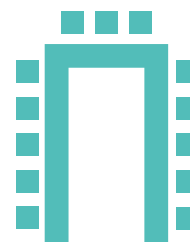

We may be able to accommodate other table styles dependent on request and event type.

FLOOR PLANS

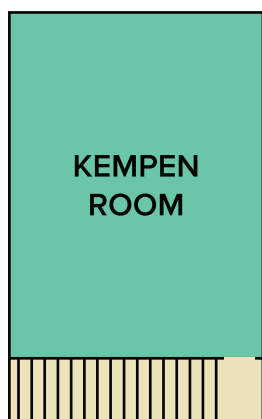
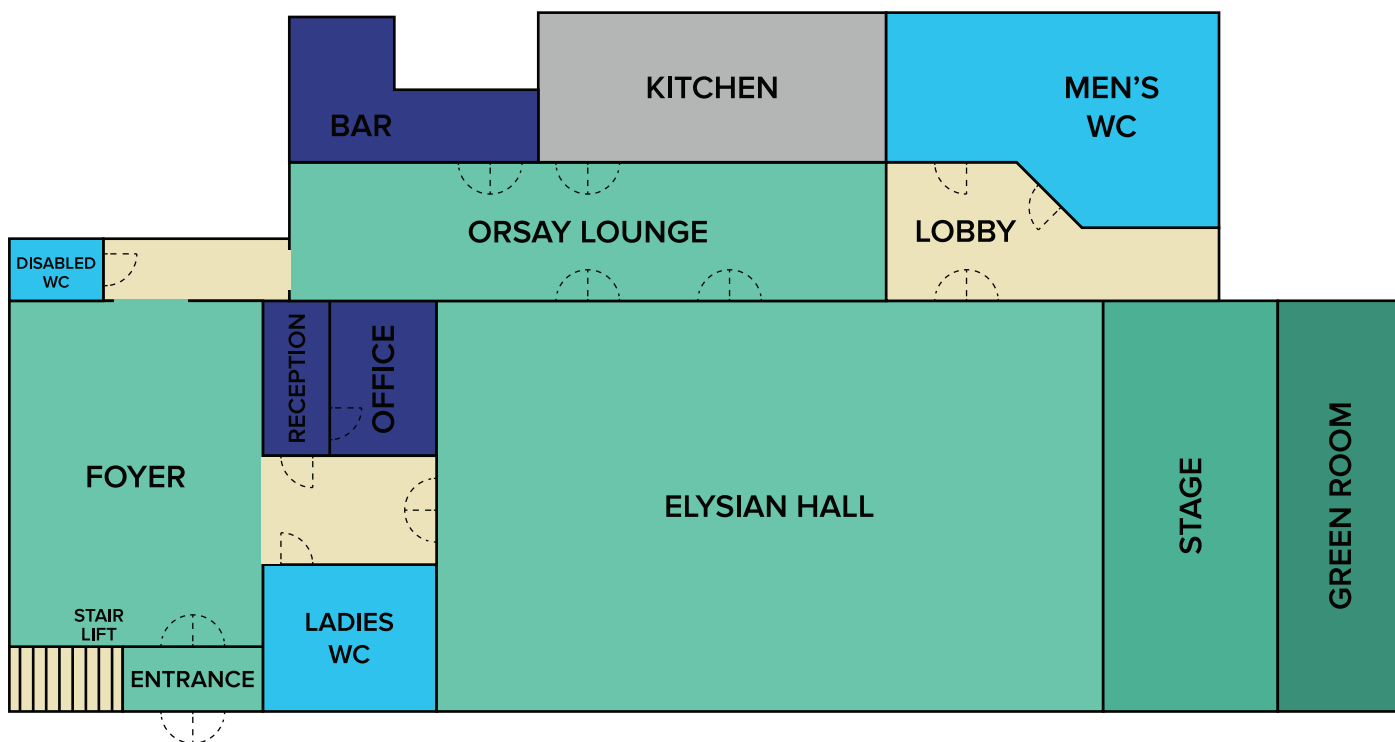

HIRE OPTIONS

Our suites are available to hire Monday to Sunday. The price table below is for hire times between 8am and 12am. We offer introductory discount on total room hire costs for first time bookers, regular bookers can also receive a negotiated rate and we offer a 10% discount for schools and registered charities.

	HALF DAY (4 HOURS)	FULL DAY (8 HOURS)	OFF PEAK (HOURLY)	PEAK (HOURLY) FRIDAYS FROM 5PM, SAT-SUN & BANK HOLS
FOYER	£46.00	£87.00	-	-
ORSAY LOUNGE	£118.00	£235.00	£32.00	£50.00
FOYER/ORSAY LOUNGE (USE FOR CATERING SERVICE. MAX 4 HRS.)	£30.00	-	-	-
KEMPEN ROOM	£220.00	£420.00	£55.00	£70.00
ELYSIAN HALL	£300.00	£580.00	£75.00	£95.00
GROUND FLOOR ELYSIAN HALL FOYER ORSAY LOUNGE STAGE AREA GREEN ROOMS	£400.00	£780.00	£100.00	£120.00
FULL VENUE ELYSIAN HALL FOYER ORSAY LOUNGE KEMPEN ROOM STAGE AREA GREEN ROOMS	£520.00	£1000.00	£130.00	£170.00

PLEASE NOTE

All prices are subject to VAT.

All hire times are from first entry (unlock the doors) to final exit, after clear down. Remember to include enough time for set up for your event and clear down after your event. If times are exceeded, all additional hours will be invoiced.

Minimum 2 hour hire applicable on all rooms and options.

ADDITIONS

EQUIPMENT

Tailor your event to your exact requirement - the following options are also available for hire:

Projector (Kempen room)	£30.00
Projector and screen (Elysian Hall)	£75.00
Flipchart and pens	£6.00 each
A5 notepad and pen	£3.00 each
Elysian Hall PA system	£30.00
Kitchen hire (required if using own catering company)	£205.00 or surcharge of £80 if bringing in own buffet - plates and napkins to be brought in

CATERING & REFRESHMENTS

We have a selection of full lunch menus to choose from, which are available to view on request. You can also add any of the following to any menu, or purchase separately:

Tea/coffee	£1.75 per person/per serving
Tea/coffee with biscuits	£2.50 per person/per serving
Orange or apple juice	£1.75 per person/per serving
Bottled still or sparkling water (1 litre)	£3.50 per bottle
Licensed bar (staffed)	£150 minimum spend

Please note all prices are subject to VAT.



LOCATION

